

INSTALLATION INSTRUCTIONS

Batten LED Fittings

Product Codes: **BF210W-1, BF420W-1, BF440W-1, BF440WE-1, BF530W-1, BF530WE-1, BF550W-1, BF550WE-1, BF630W-1, BF660W-1 & BF660WE-1**

Safety Warning



- The installation should be carried out by a qualified electrician in compliance with the current edition of the IEE Wiring Regulations.
- Prior to installation, carry out the necessary risk assessment considering the people who could be at risk, the level of risk and the precautions required to control the risk
- Ensure that the circuit supply is isolated either by the circuit supply fuse being removed or the applicable circuit breaker being turned off before installation or any maintenance.
- Check the total load on the circuit ensuring the luminaire does not exceed the rating of the circuit cable, fuse or circuit breaker.
- Long-term use and voltage fluctuations can reduce the life span of the fitting.
- If the fitting incorporates control gear, ensure careful sizing to avoid instances of nuisance tripping of the protective device used in the installation.
- Follow the provided installation instructions, using the fixings supplied or recommended.
- Keep out of reach of children.



Specification

Box Contents -
1 x Batten LED Fitting

Dimensions:	BF210W-1: L: 620 x W: 69 x D: 82mm BF420W-1: L: 1230 x W: 69 x D: 82mm BF440W/E-1: L: 1230 x W: 109 x D: 82mm BF530W/E-1: L: 1530 x W: 69 x D: 82mm BF550W/E-1: L: 1530 x W: 109 x D: 82mm BF630W-1: L: 1795 x W: 69 x D: 82mm BF660W/E-1: L: 1795 x W: 109 x D: 82mm
Material:	Powder Coated Metal Body and Polycarbonate Diffuser
Working Temperature:	Standard: -15°C - 45°C Emergency: 0°C - 45°C

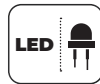
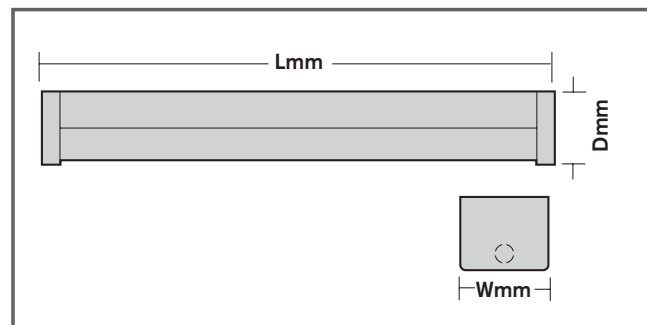

*Batteries 1 year guarantee

**IK03 - Polycarbonate Diffuser.
IK07 - Metal Body

MAXIMUM FITTINGS PER CIRCUIT

Automatic Circuit Breaker Type:	C10	C13	C16	C20
Rated Current:	10A	13A	16A	20A
Cable (mm):	1.5	1.5	1.5	2.5
BF210W-1	114	149	183	229
BF420W-1	57	74	91	114
BF440W-1	59	76	94	118
BF440WE-1	56	73	89	112
BF530W/E-1	87	114	140	175
BF550W-1	47	61	75	94
BF550WE-1	45	59	72	90
BF630W-1	78	101	125	156
BF660W-1	39	50	62	78
BF660WE-1	37	49	60	75

Installation Instructions

- Remove the appropriate circuit fuse or lock off the MCB.
- Before making any fixing hole(s), check that there are no hazards hidden beneath the mounting surface, such as pipes or cables.
- The chosen location of the new fitting should allow for the fitting to be securely mounted (e.g. to a ceiling joist) and safely connected to the mains supply (lighting circuit).
- Do not attach the fitting to surfaces which are damp or freshly painted.

5. Remove the diffuser / LED Module by squeezing the back plate and pulling diffuser firmly away.

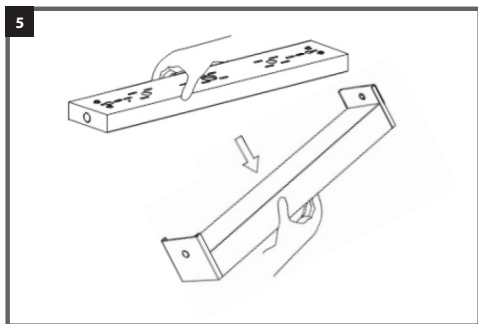

6. Thread the supply cable through the grommetted hole in the back or on the end of the fitting.
7. Secure the fitting using suitable fixings (provided) / keyhole slots, which are provided in the back of the fitting.

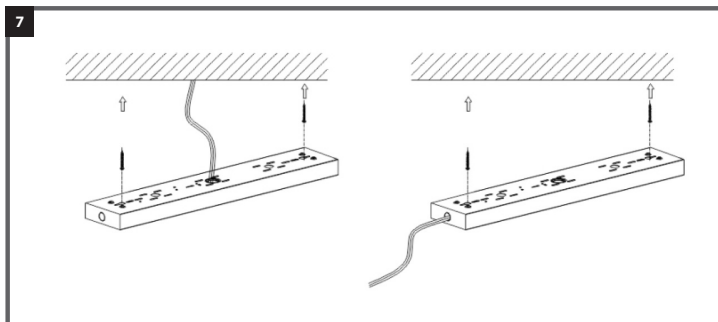

8. Connect to the electrical supply in accordance with the following code: Live = Brown, Neutral = Blue, Earth = Green and Yellow, ensuring the cable is not trapped behind / inside the fitting.
9. Hook the diffuser / LED Module to the back plate using the safety cords supplied / fitted.
10. Make electrical connection from the diffuser / LED Module to the back plate using the plug & socket fitted to each part.
11. Re-fit the diffuser / LED Module to the back plate, pushing firmly until the diffuser clicks into place over the metal profile.

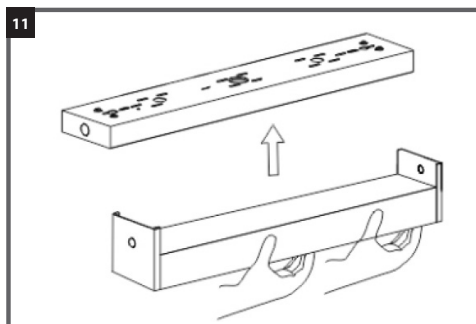
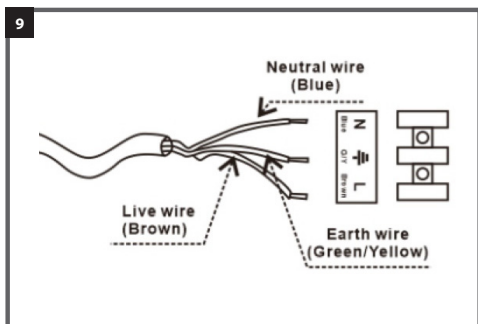

Guarantee

This product is guaranteed for a period of 5 years from the date of purchase. The guarantee is invalid in the case of improper use, tampering, removal of the Q.C. date label, installation in an improper working environment or installation not according to the current edition of the I.E.E. Wiring Regulations (BS7671). The guarantee is also invalidated if the luminaire has been insulation tested. Should this product fail during the guarantee period it will be replaced free of charge, subject to correct installation and return of the faulty unit. We do not accept responsibility for any installation costs associated with the replacement of this product. Your statutory rights are not affected. We reserve the right to alter specifications without prior notice.

Maintenance

- This fitting will require routine cleaning if used in adverse (dust, paint, welding, oils etc) environments. Do not use solvents, aggressive detergents or abrasives.
- The light source in this luminaire is not replaceable. The driver in this luminaire can be quickly and easily replaced at end of life. This should be carried out by a competent person. Contact Red Arrow for details of replacements.

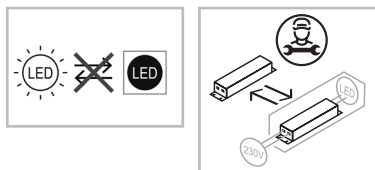

- When this fitting comes to the end of its life or you choose to replace it, please do not dispose of it with your normal waste. Please recycle where the facilities exist, check with your local authority for suitable options.

INS/COMMERCIAL/0006/BF/V3