

Safety Warning



- The installation should be carried out by a qualified electrician in compliance with the current edition of the IEE Wiring Regulations.
- Prior to installation, carry out the necessary risk assessment considering the people who could be at risk, the level of risk and the precautions required to control the risk
- Ensure that the circuit supply is isolated either by the circuit supply fuse being removed or the applicable circuit breaker being turned off before installation or any maintenance.
- Check the total load on the circuit ensuring the luminaire does not exceed the rating of the circuit cable, fuse or circuit breaker.
- Long-term use and voltage fluctuations can reduce the life span of the fitting.
- If the fitting incorporates control gear, ensure careful sizing to avoid instances of nuisance tripping of the protective device used in the installation.
- Follow the provided installation instructions, using the fixings supplied or recommended.
- Keep out of reach of children.



Specification

Box Contents -
1 x Emergency 110V LED Twin Spot

Dimensions:	L: 308 W: 309 x D: 70mm
Material:	Body: Steel Heads: Polycarbonate
Colour Temperature:	6000K
CRI:	Ra>75
LED Lifetime:	L70B50 35,000 Hrs
IP Rating:	IP20
IK Rating:	IK10
Working Temperature:	0°C to 40°C
Power Factor:	0.83
Guarantee:	2 Years

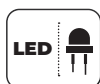
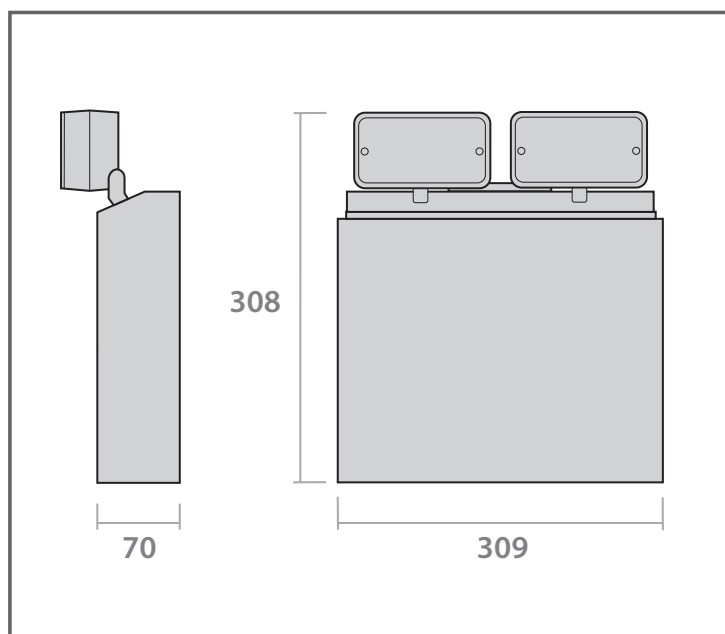

Installation Instructions

1. Remove the two screws enabling you to take off the front cover.
2. Mount the unit to the wall in the desired position, using suitable fixing screws and mounting locations.
3. The unit must be wired as per the wiring diagram in drawing number 3.
4. Route the cable correctly into the enclosure and connect the power supply to the terminal block.
5. Once the fitting has been mounted and wired the cover must be replaced and secured to ensure the IP20 integrity.
6. Replace the front cover of the unit and secure using the screws supplied.
7. Once power has been applied check to make sure the charge LED, lamp one and lamp two LED are illuminated.
8. Allow the unit to charge for at least 10 minutes and remove the mains supply to check that both LED lamps are illuminated.
9. The unit must be charged for at least 24 hours to ensure the unit will last for its duration.

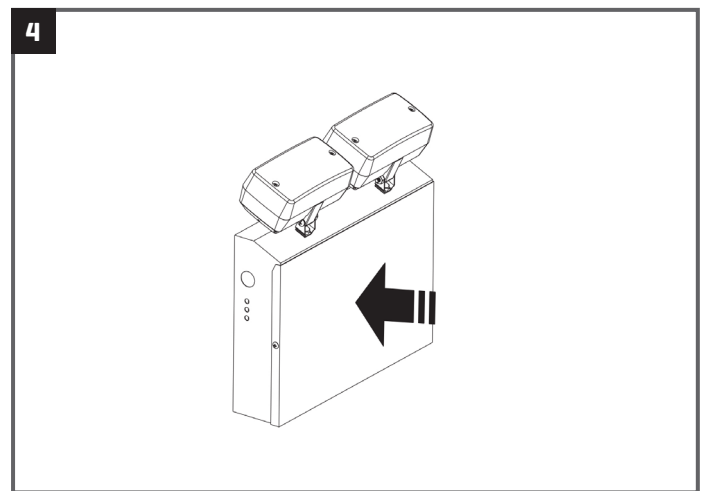
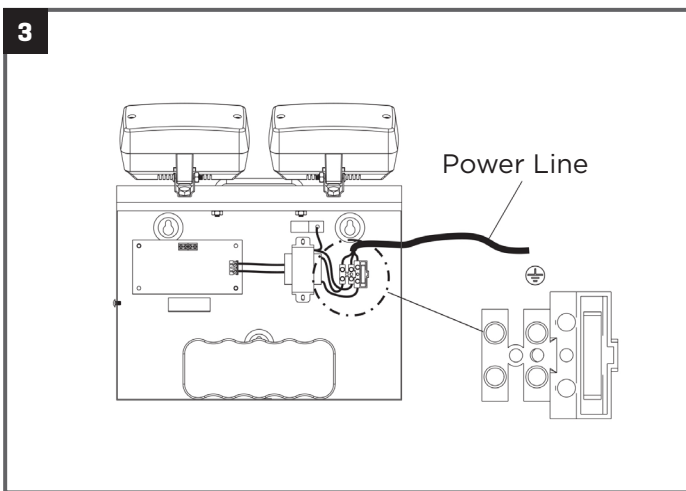
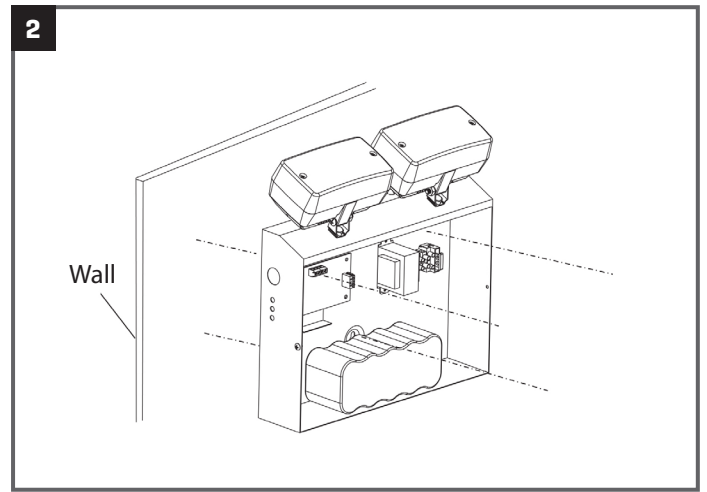
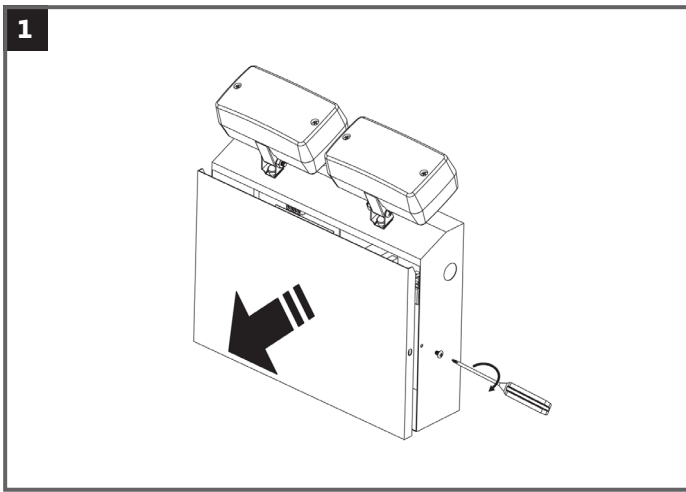

Guarantee

This product is guaranteed for a period of 2 years from the date of purchase. The guarantee is invalid in the case of improper use, tampering, removal of the Q.C. date label, installation in an improper working environment or installation not according to the current edition of the I.E.E. Wiring Regulations (BS7671). The guarantee is also invalidated if the luminaire has been insulation tested. Should this product fail during the guarantee period it will be replaced free of charge, subject to correct installation and return of the faulty unit. We do not accept responsibility for any installation costs associated with the replacement of this product. Your statutory rights are not affected. We reserve the right to alter specifications without prior notice.

Maintenance

- This fitting will require routine cleaning if used in adverse (dust, paint, welding, oils etc) environments. Do not use solvents, aggressive detergents or abrasives.
- The light source & driver in this luminaire can be quickly and easily replaced at end of life. This should be carried out by a competent person. Contact Red Arrow for details of replacements.

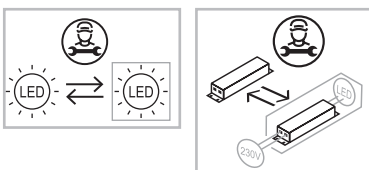

- When this fitting comes to the end of its life or you choose to replace it, please do not dispose of it with your normal waste. Please recycle where the facilities exist, check with your local authority for suitable options.

INS_SITE_0025_LF292LED-110_V1

INSTALLATION INSTRUCTIONS

Emergency Testing Sheet

Testing (Emergency Versions)

The emergency light must be tested and inspected regularly in accordance with local codes of practice.

NOTE: For safety reasons tests should be carried out preceeding time of low risk, to allow for battery recharge.

The minimum recommended test schedule is as follows:

Commissioning - After installation, allow 36 hours to ensure full battery charge, and then interrupt the supply; check after 3 hours that the lamp is still illuminated.

1. Daily - Check that the charge indicator LED is working.
2. Monthly - Interrupt the power supply for a period sufficient to ensure each lamp is illuminated. At the end of the test, restore the supply and check the indicator is illuminated.
3. Annually - Interrupt the supply as in 2, but for the full rated duration. Ensure the lamp is illuminated at the end of the rated duration. Restore the supply and check the indicator is illuminated.
4. Record the date and result of each test, attending to any maintenance required in the event of a test failure.

Luminaire Location **Date Installed**

Date Commisioned

Month	Test	Year 1			Year 2			Year 3		
		Signed	Result / Action	Date	Signed	Result / Action	Date	Signed	Result / Action	Date
1	Functional									
2	Functional									
3	Functional									
4	Functional									
5	Functional									
6	Functional									
7	Functional									
8	Functional									
9	Functional									
10	Functional									
11	Functional									
12	Full Duration									