

INSTALLATION INSTRUCTIONS

8W Circular Gear Tray
 Product Codes: **GTC8-40**

Safety Warning



- The installation should be carried out by a qualified electrician in compliance with the current edition of the IEE Wiring Regulations.
- Prior to installation, carry out the necessary risk assessment considering the people who could be at risk, the level of risk and the precautions required to control the risk.
- Ensure that the circuit supply is isolated either by the circuit supply fuse being removed or the applicable circuit breaker being turned off before installation or any maintenance.
- Check the total load on the circuit ensuring the luminaire does not exceed the rating of the circuit cable, fuse or circuit breaker.
- Long-term use and voltage fluctuations can reduce the life span of the fitting.
- If the fitting incorporates control gear, ensure careful sizing to avoid instances of nuisance tripping of the protective device used in the installation.
- Follow the provided installation instructions, using the fixings supplied or recommended.
- Keep out of reach of children.



Specification

Box Contents -
 1 x 8W Circular Gear Tray

Dimensions:	Ø: 185 x D: 32mm
Material:	Phenolic Resin
Working Temperature:	Standard: -20°C - 40°C
Included:	Fast Fit Terminal Block

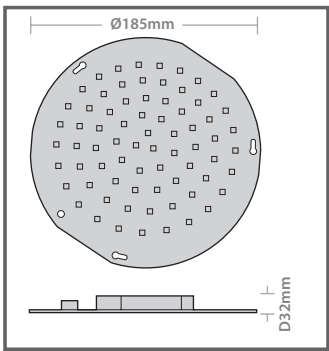

MAXIMUM FITTINGS PER CIRCUIT

Automatic Circuit Breaker Type:	B6	B10	B13	B16	B20	C10	C13	C16	C20
Rated Current:	6A	10A	13A	16A	20A	10A	13A	16A	20A
Cable (mm):	1.5	1.5	1.5	1.5	2.5	1.5	1.5	1.5	2.5
GTC8-40	40	70	90	120	150	70	90	120	150

Installation Instructions

Note: This is a Class II electrical product - no earth required

- Isolate the mains supply before commencing with the installation.
- Install the Red Arrow Robust Mini Round body only.
 - Or
 - Prepare existing housing ready to install gear tray - checking that the retaining screw positions are compatible with those of the gear tray.
- Feed the mains cable into the housing.
 - If the housing is not already installed, hold the fitting up to the ceiling / wall in the desired position and mark hole fixing centres.
 - Drill fixing holes.
 - Insert rawl plugs.
 - Fix in position.
- Ensure the gear tray has a switched live supply to "L" (switched live). Route the mains supply cable to the terminal block on the gear tray and terminate, ensuring correct polarity is observed. Ensure all conductors are fully sleeved and insulated.

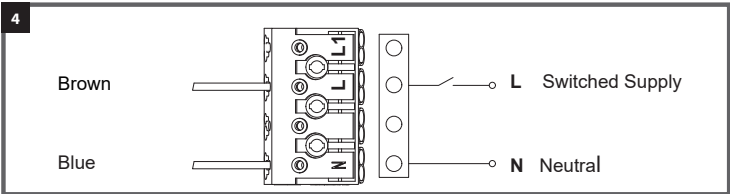

5. Fit the gear tray and secure by placing onto retaining screws, twisting to lock the screws into the keyhole slots & then tightening the screws.

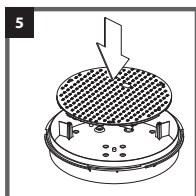

6. Refit the diffuser onto the housing.

Restore the mains power supply, switch on and test for satisfactory operation.

Important: This gear tray is designed for use with Red Arrow Robust Mini Round Empty Bodies. When installing this gear tray into an existing housing not supplied by Red Arrow, we strongly recommend that the internal volume of the housing is no less than 2100cm³ (2.1 litres), for thermal considerations.

Guarantee

This product is guaranteed for a period of 5 years from the date of purchase. The guarantee is invalid in the case of improper use, tampering, removal of the Q.C. date label, installation in an improper working environment or installation not according to the current edition of the I.E.E. Wiring Regulations (BS7671). The guarantee is also invalidated if the luminaire has been insulation tested. Should this product fail during the guarantee period it will be replaced free of charge, subject to correct installation and return of the faulty unit. We do not accept responsibility for any installation costs associated with the replacement of this product. Your statutory rights are not affected. We reserve the right to alter specifications without prior notice.

Maintenance

- This fitting will require routine cleaning if used in adverse (dust, paint, welding, oils etc) environments. Do not use solvents, aggressive detergents or abrasives.
- The light source & driver in this luminaire can be quickly and easily replaced at end of life. This should be carried out by a competent person. Contact Red Arrow for details of replacements.

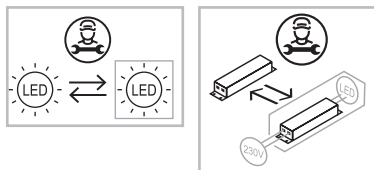

- When this fitting comes to the end of its life or you choose to replace it, please do not dispose of it with your normal waste. Please recycle where the facilities exist, check with your local authority for suitable options.

INS/COMMERCIAL/0008/GTC8/V5