

INSTALLATION INSTRUCTIONS

Linear Slimline Surface Luminaires

Product Codes: **LINA220W-40, LINA220W-60, LINA440W-40, LINA440W-60, LINA560W-40, LINA560W-60, LINA675W-40 & LINA675W-60**

Safety Warning



- The installation should be carried out by a qualified electrician in compliance with the current edition of the IEE Wiring Regulations.
- Prior to installation, carry out the necessary risk assessment considering the people who could be at risk, the level of risk and the precautions required to control the risk
- Ensure that the circuit supply is isolated either by the circuit supply fuse being removed or the applicable circuit breaker being turned off before installation or any maintenance.
- Check the total load on the circuit ensuring the luminaire does not exceed the rating of the circuit cable, fuse or circuit breaker.
- Long-term use and voltage fluctuations can reduce the life span of the fitting.
- If the fitting incorporates control gear, ensure careful sizing to avoid instances of nuisance tripping of the protective device used in the installation.
- Follow the provided installation instructions, using the fixings supplied or recommended.
- Keep out of reach of children.



Specification

Box Contents -
1 x Linear Slimline Surface Luminaire

Dimensions:	LINA220W-40/60: L: 580 x W: 80 x D: 36mm LINA440W-40/60: L: 1190 x W: 80 x D: 36mm LINA560W-40/60: L: 1480 x W: 80 x D: 36mm LINA675W-40/60: L: 1780 x W: 80 x D: 36mm
Material:	Aluminium Body & Polycarbonate Diffuser
Working Temperature:	Standard: -20°C - 40°C
Included:	2/3 x Clips, 2/3 x Plugs & 2/3 Screws

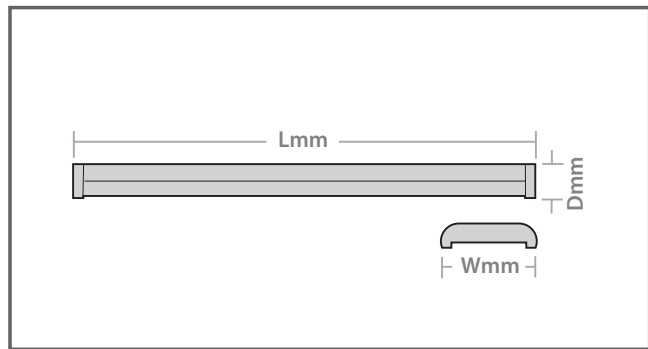

MAXIMUM FITTINGS PER CIRCUIT

Automatic Circuit Breaker Type:	C10	C13	C16	C20
Rated Current:	10A	13A	16A	20A
Cable (mm):	1.5	1.5	1.5	2.5
LINA220W-40/60:	85	110	120	170
LINA440W-40/60:	42	55	60	85
LINA560W-40/60:	28	36	40	56
LINA675W-40/60:	22	29	36	45

Installation Instructions

- Mark the desired position for mounting and drill holes of suitable size for wall plugs.
- Insert wall plugs and fasten the clips securely to the ceiling.

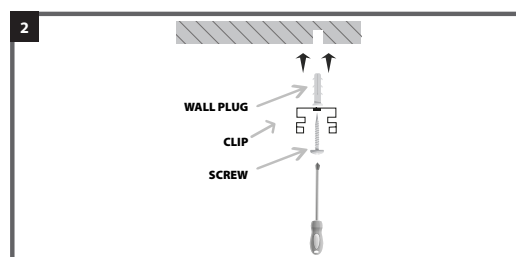
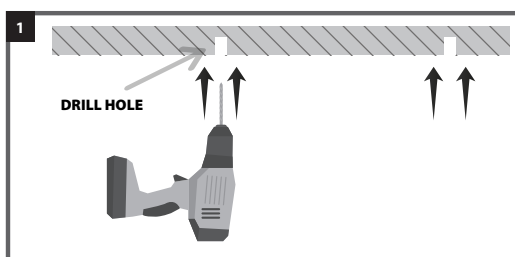

3. Install the fitting on to the mounting clips.

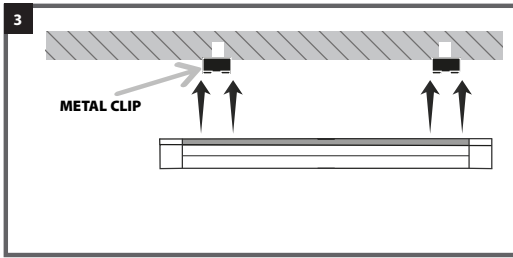

4. Adjust the position of the fitting as required and then push to engage onto the clips.

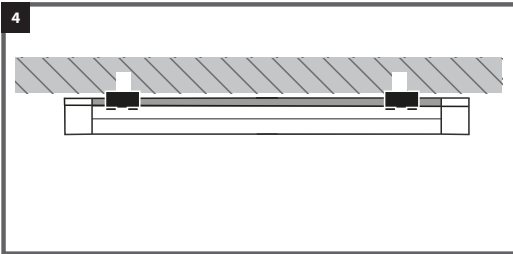

Additional Information

- To remove the fitting from the ceiling, push it away from yourself sideways 90 degrees to the long edge, then tilt down the side closest to disengage it from the clips.
- This is a Class I electrical device and must be earthed.
- There is no emergency lighting conversion for this range.

Guarantee

This product is guaranteed for a period of 3 years from the date of purchase. The guarantee is invalid in the case of improper use, tampering, removal of the Q.C. date label, installation in an improper working environment or installation not according to the current edition of the I.E.E. Wiring Regulations (BS7671). The guarantee is also invalidated if the luminaire has been insulation tested. Should this product fail during the guarantee period it will be replaced free of charge, subject to correct installation and return of the faulty unit. We do not accept responsibility for any installation costs associated with the replacement of this product. Your statutory rights are not affected. We reserve the right to alter specifications without prior notice.

Maintenance

- This fitting will require routine cleaning if used in adverse (dust, paint, welding, oils etc) environments. Do not use solvents, aggressive detergents or abrasives.
- The light source & driver in this luminaire can not be replaced. When this fitting comes to the end of its life or you choose to replace it, please do not dispose of it with your normal waste. Please recycle where the facilities exist, check with your local authority for suitable options.

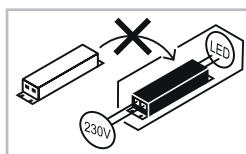

INS/COMMERCIAL/0004/LINA/V5