

TAURUS IP65 BULKHEADS

Product Codes: **TA05, TA05/MS, TA05/PC**

Safety Warning



- The installation should be carried out by a qualified electrician in compliance with the current edition of the IEE Wiring Regulations.
- Prior to installation, carry out the necessary risk assessment considering the people who could be at risk, the level of risk and the precautions required to control the risk.
- Ensure that the circuit supply is isolated either by the circuit supply fuse being removed or the applicable circuit breaker being turned off before installation or any maintenance.
- Check the total load on the circuit ensuring the luminaire does not exceed the rating of the circuit cable, fuse or circuit breaker.
- Long-term use and voltage fluctuations can reduce the life span of the fitting.
- If the fitting incorporates control gear, ensure careful sizing to avoid instances of nuisance tripping of the protective device used in the installation.
- Follow the provided installation instructions, using the fixings supplied or recommended.
- Keep out of reach of children.



Specification

Box Contents -
1 x Taurus Bulkhead

Dimensions:	L: 249 x W: 129 x D: 97mm
Material:	Polycarbonate
Working Temperature:	-10°C - 40°C
Included:	Accessory Kit - 4x fixing screws and wall plugs, blind grommet.

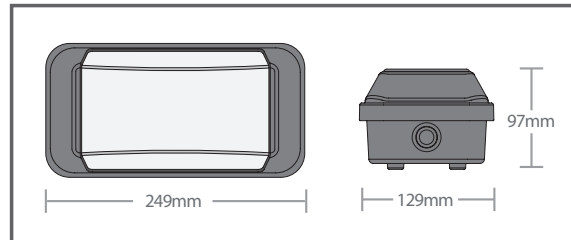

MAXIMUM FITTINGS PER CIRCUIT

Automatic Circuit Breaker Type:	B6	B10	B13	B16	B20	C10	C13	C16	C20
Rated Current:	6A	10A	13A	16A	20A	10A	13A	16A	20A
Cable (mm):	1.5	1.5	1.5	2.5	2.5	1.5	1.5	2.5	2.5
TA05	165	270	360	440	550	460	600	740	920
TA05/MS & TA05/PC	150	245	345	425	535	445	585	725	905

Installation Instructions

- Select the preferred installation position and check to ensure there are no obstructions, pipes or concealed cables before drilling any fixing holes.
- Remove the trim by unclipping at one end and pulling away from the diffuser, then remove the diffuser by loosening the retaining screws.
- Loosen the retaining screws on the gear tray and remove from the bulkhead.
- Select one of the cable entry points on the back or sides of the base and drill through.
- Feed the supply cable through the hole, sealing the entry by using the grommet supplied or a suitable cable gland to retain the IP rating.

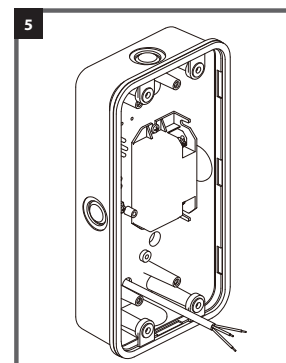
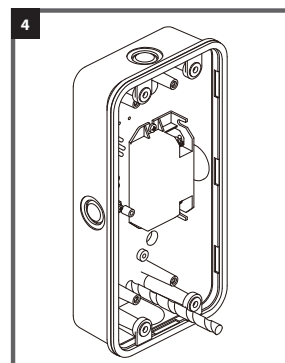
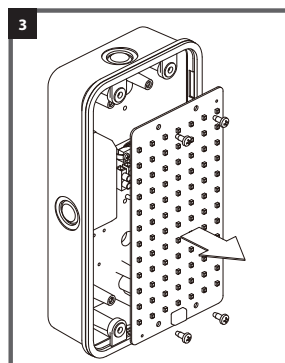
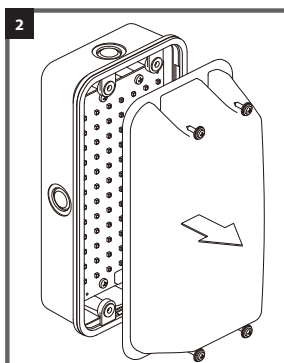

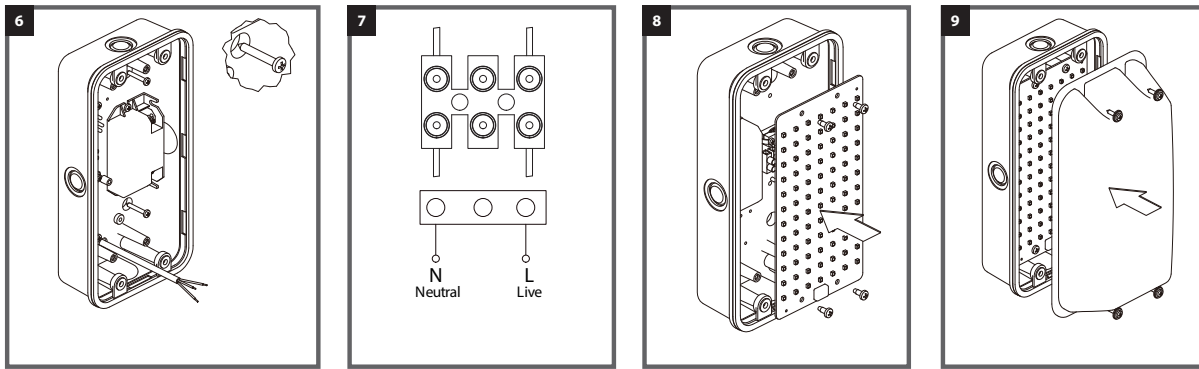

6. Position and fix the base to the mounting surface, using the screws provided at the four fixing positions.
7. Terminate the supply cable into the terminal block on the rear of the gear tray, observing correct polarity. Ensure all conductors are fully sleeved and insulated against heat. This fitting is Class II Double Insulated. No earth connection is required.
8. Replace the gear tray and tighten the retaining screws.
9. Replace the diffuser and tighten the retaining screws, ensuring no cables are trapped.
10. Replace the trim (if required) by locating the pip under the base lip at one end then firmly push and click the trim into position.
11. Restore the power supply and check for correct operation

Photocell Version – TAO5/PC

- The built-in photocell will automatically turn the luminaire on at dusk (approx. 10-20 lux) and off at dawn (approx.. 30-60 lux)
- When selecting a mounting position, do not install with the photocell facing any artificial or reflected light, as this may cause the fitting to cycle on and off at night

Microwave Sensor Version – TAO5/MS

- When selecting a mounting position, consider the following
 - Optimum sensor performance is achieved with the fitting mounted at 2.5m above ground level
 - Avoid positioning close to trees or shrubs which may cause false triggering
 - Avoid facing any artificial or reflected light as the sensor may fail to trigger due to the daylight threshold settings
- Switching is fully automatic and settings can be adjusted using the dip switches that can be accessed from the front of the gear tray with the diffuser removed. See instructions and diagrams below for set up adjustments
- Sensitivity range can be adjusted by selecting a combination of dip switches 1 and 2. When set at 100% sensitivity the detection range is: Wall – up to 8m when mounted at 2m above ground level; Ceiling – up to 5m in all directions when mounted at 2.5-5m above ground level
- Hold-time is adjusted using dip switch 3 and 4 and is the time period the fitting remains on after the last movement is detected
- Daylight threshold is adjusted using dip switch 5 and 6. An ambient daylight level can be selected, below which the sensor will operate and switch the fitting on/off dependant on movement. E.g. If set at 2 lux, the fitting will only turn on when movement is detected if the ambient light level is below 2 lux. The fitting will always turn on when movement is detected if the daylight threshold is disabled.

Sensitivity

I – 100%	● ●	100%
II – 75%	● ○	75%
III – 50%	○ ●	50%
IV – 10%	○ ○	10%

Hold Time

I – 5s	● ●	5s
II – 90s	● ○	90s
III – 5min	○ ●	5min
IV – 15min	○ ○	15min

Daylight Threshold

I – Disable	● ●	Disable
II – 50Lux	● ○	50Lux
III – 10Lux	○ ●	10Lux
IV – 2Lux	○ ○	2Lux

Guarantee

This product is guaranteed for a period of 3 years from the date of purchase. The guarantee is invalid in the case of improper use, tampering, removal of the Q.C. date label, installation in an improper working environment or installation not according to the current edition of the I.E.E. Wiring Regulations (BS7671). The guarantee is also invalidated if the luminaire has been insulation tested. Should this product fail during the guarantee period it will be replaced free of charge, subject to correct installation and return of the faulty unit. We do not accept responsibility for any installation costs associated with the replacement of this product. Your statutory rights are not affected. We reserve the right to alter specifications without prior notice.

Maintenance

- This fitting will require routine cleaning if used in adverse (dust, paint, welding, oils etc) environments. Do not use solvents, aggressive detergents or abrasives.
- The LEDs and Driver in this product can be replaced at the end of life. This must be carried out by a professional, competent person.

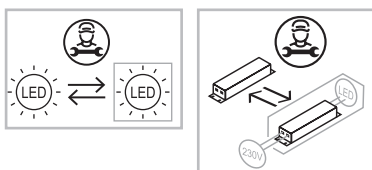

- When this fitting comes to the end of its life or you choose to replace it, please do not dispose of it with your normal waste. Please recycle where the facilities exist, check with your local authority for suitable options.

INS/OUTDOOR/0008/TA/V2