

Discus Max Downlights

Product Codes: **DSM1528-CCT & DSM1528PIR-CCT**

Safety Warning



- The installation should be carried out by a qualified electrician in compliance with the current edition of the IEE Wiring Regulations.
- Prior to installation, carry out the necessary risk assessment considering the people who could be at risk, the level of risk and the precautions required to control the risk
- Ensure that the circuit supply is isolated either by the circuit supply fuse being removed or the applicable circuit breaker being turned off before installation or any maintenance.
- Check the total load on the circuit ensuring the luminaire does not exceed the rating of the circuit cable, fuse or circuit breaker.
- Long-term use and voltage fluctuations can reduce the life span of the fitting.
- If the fitting incorporates control gear, ensure careful sizing to avoid instances of nuisance tripping of the protective device used in the installation.
- Follow the provided installation instructions, using the fixings supplied or recommended.
- Keep out of reach of children.



Specification

Box Contents -
1 x Discus Max Downlight

Dimensions:	Ø: 330 x D: 25mm
Material:	Body: PC & Aluminium Diffuser: PS
Working Temperature:	Standard: -20°C - 40°C
Included:	30cm Cable Flicker free driver Mounting Bracket Plastic Clips Screw Terminal Block

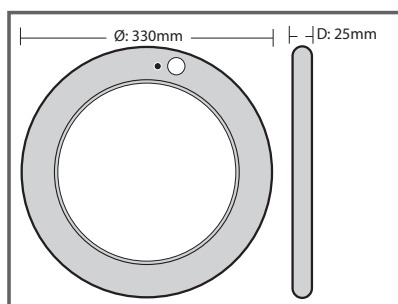

Maximum Fittings per Circuit

Automatic Circuit Breaker Type:	B6	B10	B13	B16	B20	C10	C13	C16	C20
Rated Current:	6A	10A	13A	16A	20A	10A	13A	16A	20A
Cable (mm):	1.5	1.5	1.5	1.5	2.5	1.5	1.5	1.5	2.5
DSM1528-CCT & DSM1528PIR-CCT (15W)	69	103	103	103	172	103	103	103	172
DSM1528-CCT & DSM1528PIR-CCT(22W)	47	70	70	70	117	70	70	70	117
DSM1528-CCT & DSM1528PIR-CCT(28W)	37	55	55	55	92	55	55	55	92

Installation Instructions - Semi-Recessed Mounting

- Before cutting, ensure that the hole does not impinge on joists, pipe work, cables or other building services.
- Adjust the springs to the required position to fit the cut-out, using the measurement guides marked on the bracket.

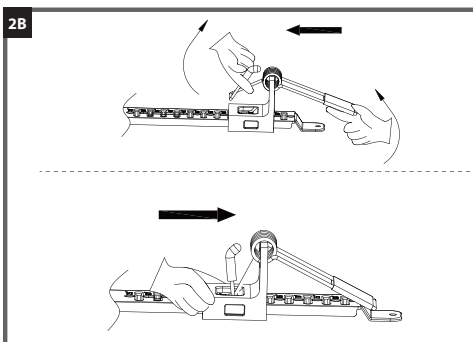
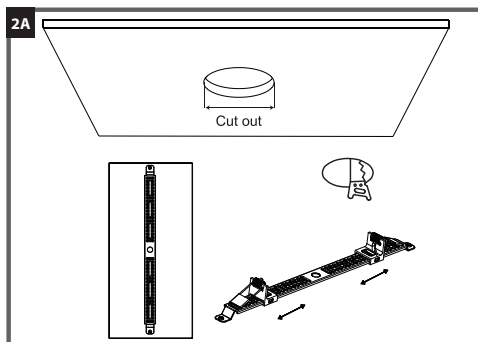

3. Attach the bracket to the fitting, align the ends of the bracket with the slots / keyways and then twist clockwise to engage.

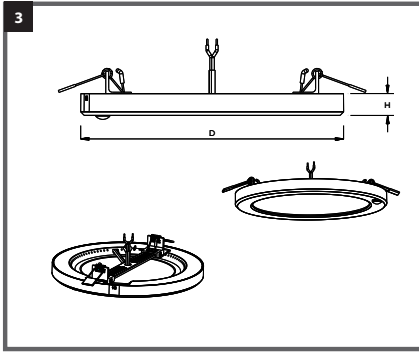

4. Connect the power supply cable to the terminal in the junction box: Brown to Live, Blue to Neutral.
5. Offer the luminaire up to the cut-out. Hold retention springs vertically, push fitting through the cut-out until the springs come down on the upper side of the plasterboard.

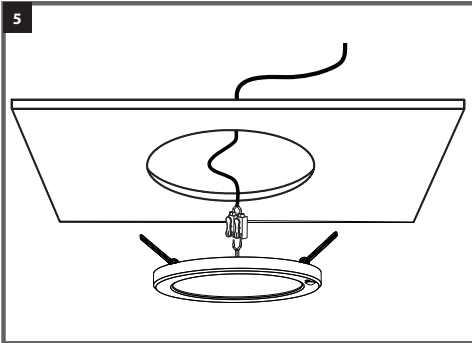

Surface Mounting

1. Twist and remove bracket from the fitting.

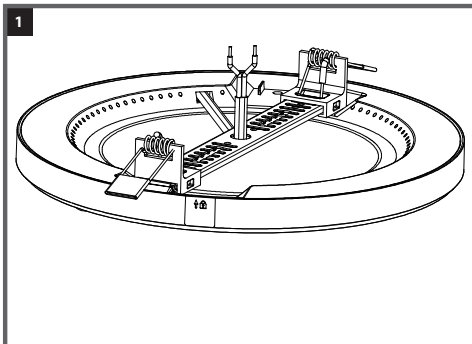

2. Remove the extension springs from the bracket.
3. Attach the bracket to the surface ceiling or wall using screws.
4. Make a hole in the wall or ceiling for the junction box.

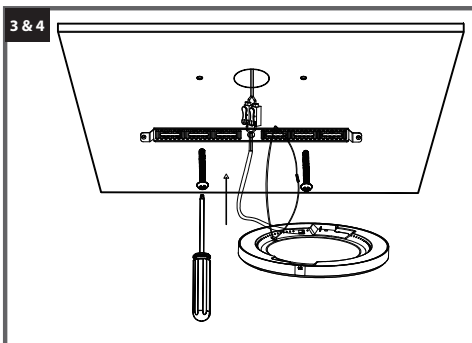

5. Connect the supply in the suitable junction box: Brown to Live, Blue to Neutral.

6. Attach the fitting to the bracket by twist and lock mechanism.

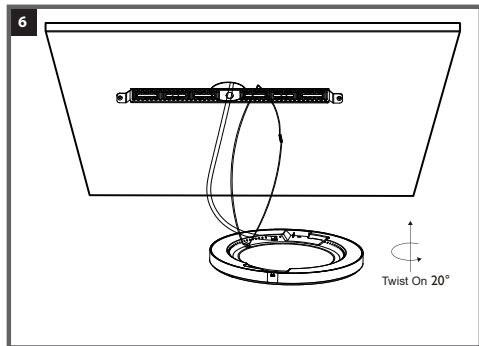

Wattage & Colour Temperature Selectable Instructions

1. Use the selector switch, located behind the bezel, to switch between 15W, 22W & 28W.
2. Use the selector switch, located behind the bezel, to switch between 3000K, 4000K & 5700K.

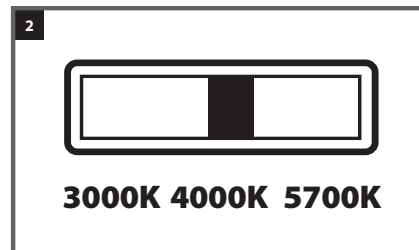
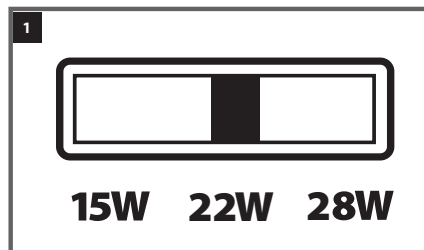

Wattage Selectable with PIR

- A. Switch 1: Select a switch off delay of 30 seconds or 180 seconds after last presence detected.
- B. Switch 2: Select the Sun symbol to disable photocell so that the PIR operates regardless of available ambient daylight level. Select the Moon symbol to enable the photocell so that the PIR only operates the luminaire if there is insufficient daylight.
- C. Switch 3: Turn the PIR sensor on or off. Selecting off disables the PIR and the luminaire has to be switched via a suitable wall switch.

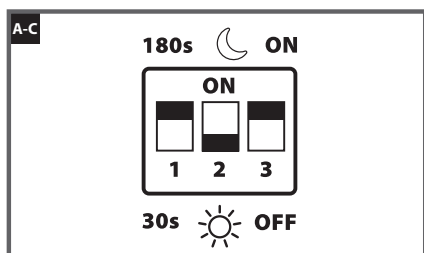

Guarantee

This product is guaranteed for a period of 3 years from the date of purchase. The guarantee is invalid in the case of improper use, tampering, removal of the Q.C. date label, installation in an improper working environment or installation not according to the current edition of the I.E.E. Wiring Regulations (BS7671). The guarantee is also invalidated if the luminaire has been insulation tested. Should this product fail during the guarantee period it will be replaced free of charge, subject to correct installation and return of the faulty unit. We do not accept responsibility for any installation costs associated with the replacement of this product. Your statutory rights are not affected. We reserve the right to alter specifications without prior notice.

Maintenance

- This fitting will require routine cleaning if used in adverse (dust, paint, welding, oils etc) environments. Do not use solvents, aggressive detergents or abrasives.
- The light source & driver in this luminaire are non-replaceable.

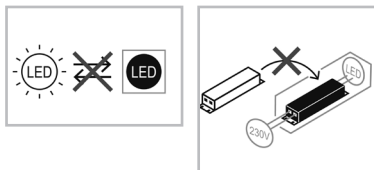

- When this fitting comes to the end of its life or you choose to replace it, please do not dispose of it with your normal waste. Please recycle where the facilities exist, check with your local authority for suitable options.

INS/COMMERCIAL/0013/DSM/V1