

INSTALLATION INSTRUCTIONS

Apollo Plug and Play 3Hr Emergency Kit (Selectable Standard/Self Test)

Product Codes: **APOL/KIT/EMST**

Safety Warning



- The installation should be carried out by a qualified electrician in compliance with the current edition of the IEE Wiring Regulations.
- Prior to installation, carry out the necessary risk assessment considering the people who could be at risk, the level of risk and the precautions required to control the risk
- Ensure that the circuit supply is isolated either by the circuit supply fuse being removed or the applicable circuit breaker being turned off before installation or any maintenance.
- Check the total load on the circuit ensuring the luminaire does not exceed the rating of the circuit cable, fuse or circuit breaker.
- Long-term use and voltage fluctuations can reduce the life span of the fitting.
- If the fitting incorporates control gear, ensure careful sizing to avoid instances of nuisance tripping of the protective device used in the installation.
- Follow the provided installation instructions, using the fixings supplied or recommended.
- Keep out of reach of children.



Specification

Box Contents -
1 x 3Hr Emergency Pack

Dimensions:	L: 97 x W: 65 x D: 22.5mm
Material:	Polycarbonate
Working Temperature:	0°C - 50°C
Warranty:	5 Year

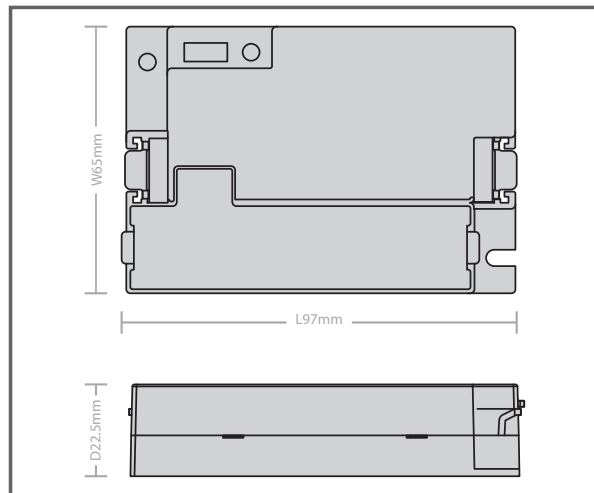

Installation Instructions

Note: This is a Class II Luminaire - No Earth required

1. Isolate the mains supply before commencing with the installation.
2. Note: This emergency kit is only compatible with the Red Arrow Apollo Bulkhead.
3. Locate the emergency pack installation position and orientation. Locate the emergency pack onto the mounting legs on the base as shown below. Ensure that both mounting legs and clip are correctly engaged and secure before moving onto the next stages.

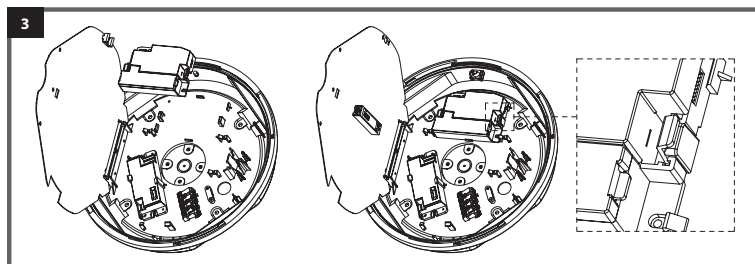
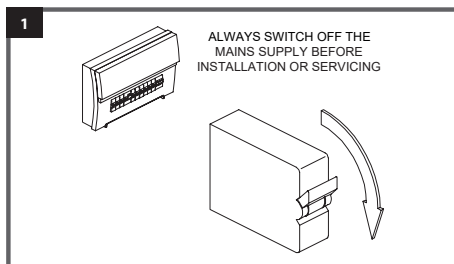

- Releasing the locking arm first on each connector disconnect the A-B & C-D connectors shown below.
- Following the below wiring diagram re connect all connectors following the below A-A, B-B, C-C, D-D ensuring all are securely connected and locking arm is engaged.

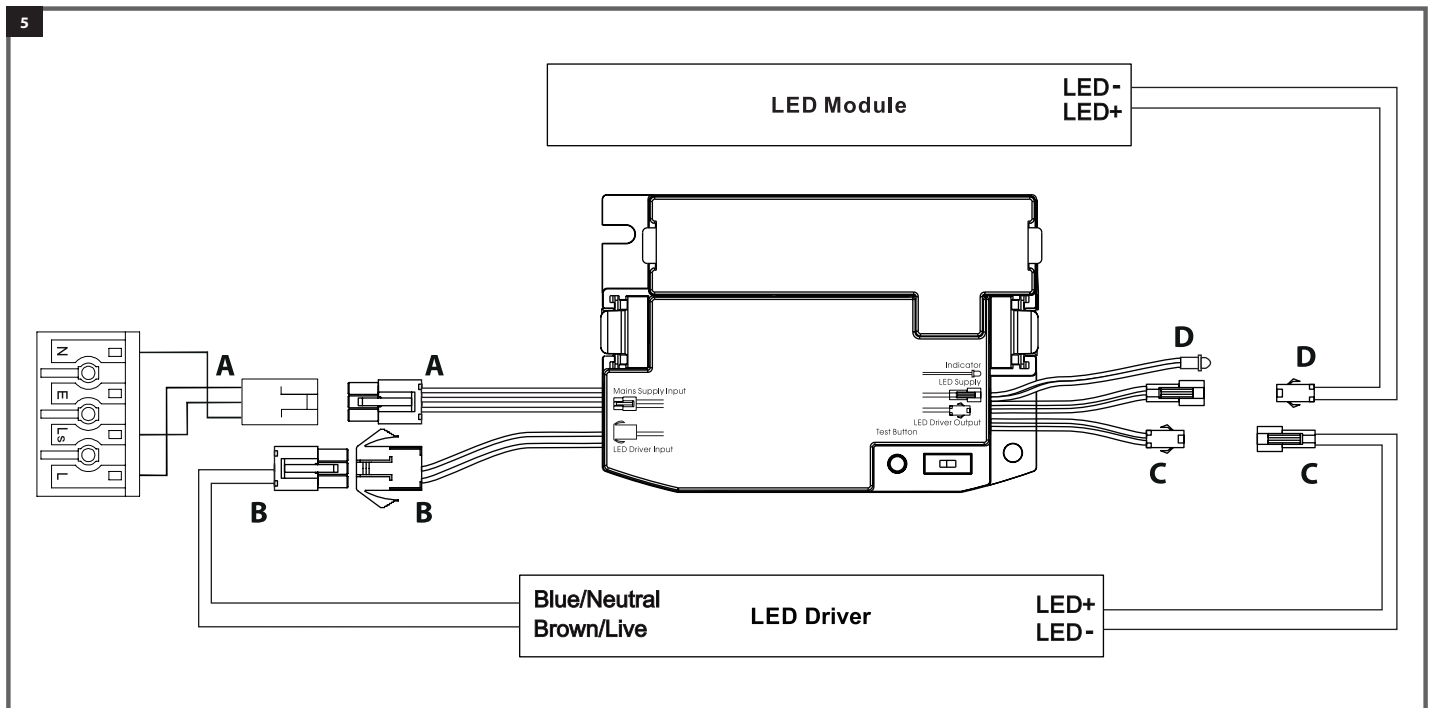

- Ensure the luminaire has a switched live supply to "Ls" and unswitched live supply "L".

Note: If converting to Emergency with the EM Kit the luminaire will require a secondary unswitched live supply "L" as well as a switched supply. The unswitched supply "L" must be taken from the same phase as the "switched" supply and must be wired to the same MCB so that upon test, it is isolated at the same time as the switched supply.

- Fit the LED Indicator into the LED Tray using the supplied bracket

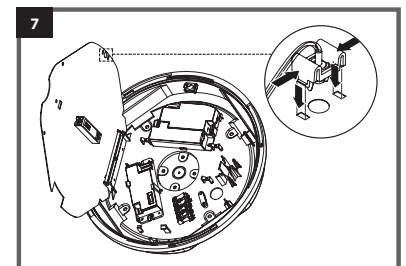
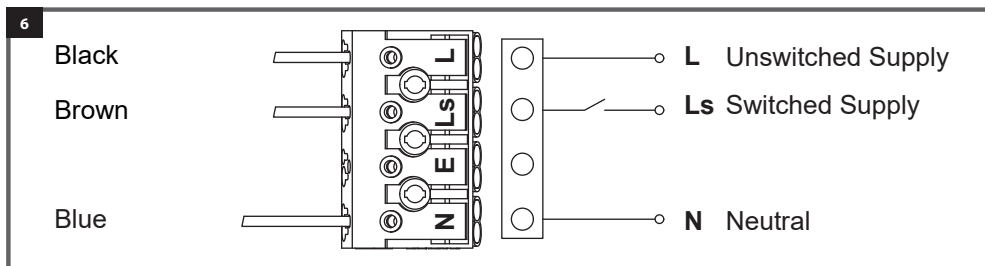

- Before powering up open the battery cover and connect the battery cell as shown below.
- As default the emergency pack will be set to self test mode (1), if manual test is required change the switch to Manual test (ON).

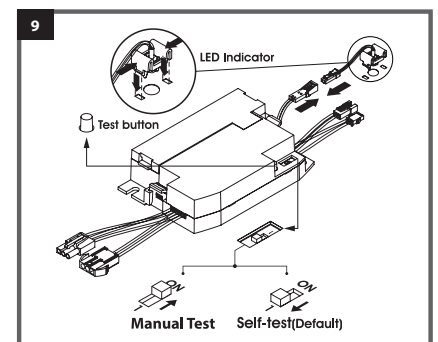
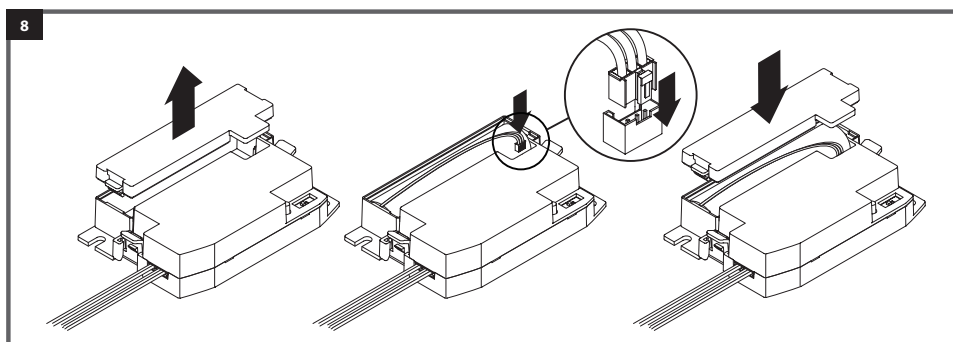

The fitting will then perform the following tests automatically, which meet and exceed legal requirements.

The status during and after the tests is provided by a bi-colour LED Indicator.

Initial Function & Duration Test

With the battery connected and an un-switched supply the green indicator will immediately flash for 1 second to indicate a pending duration test. A function test will occur after 5 minutes to allow for the battery to have some charge. A duration test will initiate between 24-48 Hours after the power supply has been connected and the batteries have charged for a minimum of 24 hours. This test lasts for the rated duration of the luminaire, 3 hours.

Function Test

A 108 Second Function test will be performed every 7 days, checking the functionality of the emergency module, batteries and LED module.

Duration Test











This is carried out every half year (every 182 to 189 days). The test lasts for the rated duration of the luminaire, 3 hours.

NOTES:

If a mains supply failure occurs during a scheduled test or in the preceding 24 hours, the test will be postponed and the LED indicator will flash GREEN to identify a pending duration and remain test until the test has been completed.

System Status Indication

The system status, including testing and any faults is provided by a bi-colour LED indicator on the fitting. Status is provided as follows:

LED Colour	Status	Flash Rate On Time	Flash Rate Off Time	Details	
Green		Permanent On	-	-	Normal operation - Battery is charging
		Slow Flash	0.5s	0.5s	Pending Duration Test
		Medium Flash	0.25s	0.25s	Duration Test in Progress
		Fast Flash	0.125s	0.125s	Function Test in Progress
Red		Permanent On	-	-	Battery Charge Failure
		Medium Flash	0.25s	0.25s	Battery Duration Failure
		Fast Flash	0.125s	0.125s	LED Module Failure
		Off 1s / Stay Red 5s	5.0s	1.0s	26 Weeks Duration Test Interval
		Off 1s / Fast Flash Red for 5s	0.125s	0.125s	52 Weeks Duration Test Interval
Off		Off	-	-	System in emergency mode. Mains disconnected from battery, or mains failure

Test Button

The emergency pack has a manual test button which can be used to perform the following functions:

Standard & Self Test Mode;

Press for 1-2s – Manual functional test

Press for 5-10s – Manual duration test

Double Press <1s (During Emergency Mode) - Rest Mode

Self Test Mode ONLY;

Press for <1s - Confirm current test interval

Double Press <1s - Set the duration test Interval

Battery Replacement

1. Isolate the mains supply and remove the front cover.
2. Unplug the battery lead from the circuit board.
3. Write the current date on the new battery pack.
4. Fit the new battery pack.
5. Plug the battery back into the circuit board.
6. Replace the front cover, restore the power and allow to charge for 24 hours. Then carry out a full duration test.
7. Self Test Version Only – After restoring the power press the test button for >10s to reset the timer and allow to charge for 24 hours.
8. Self Test Version Only – The fitting will carry out an automatic duration test after 24 hours. Check the indicator status after the test for normal operation

Warranty

This product is guaranteed for a period of 5 years from the date of purchase. The warranty is invalid in the case of improper use, tampering, removal of the Q.C. date label, installation in an improper working environment or installation not according to the current edition of the I.E.E. Wiring Regulations (BS7671). The warranty is also invalidated if the luminaire has been insulation tested. Should this product fail during the warranty period it will be replaced free of charge, subject to correct installation and return of the faulty unit. We do not accept responsibility for any installation costs associated with the replacement of this product. Your statutory rights are not affected. We reserve the right to alter specifications without prior notice.

Maintenance

- Contact Red Arrow for details of replacements.
- When this fitting comes to the end of its life or you choose to replace it, please do not dispose of it with your normal waste. Please recycle where the facilities exist, check with your local authority for suitable options.

INS/ACCESSORIES/0010/APOL-KIT-EMST/V1

INSTALLATION INSTRUCTIONS

Emergency Testing Sheet

Testing (Emergency Versions)

The emergency lighting must be tested and inspected regularly in accordance with local codes of practice.

NOTE: For safety reasons tests should be carried out preceeding time of low risk, to allow for battery recharge.

The minimum recommended test schedule is as follows:

Commissioning - After installation, allow 24 hours to ensure full battery charge, and then interrupt the supply; check after 3 hours that the light is still illuminated.

1. Daily - Check that the charge indicator LED is working.
2. Monthly - Interrupt the power supply for a period sufficient to ensure each light is illuminated. At the end of the test, restore the supply and check the indicator is illuminated.
3. Annually - Interrupt the supply as in 2, but for the full rated duration. Ensure the light is illuminated at the end of the rated duration. Restore the supply and check the indicator is illuminated.
4. Record the date and result of each test, attending to any maintenance required in the event of a test failure.

Luminaire Location

Date Installed

Date Commissioned

Month	Test	Year 1			Year 2			Year 3		
		Signed	Result / Action	Date	Signed	Result / Action	Date	Signed	Result / Action	Date
1	Functional									
2	Functional									
3	Functional									
4	Functional									
5	Functional									
6	Functional									
7	Functional									
8	Functional									
9	Functional									
10	Functional									
11	Functional									
12	Full Duration									

Fill in the emergency identification label as below table and apply to the luminaire in a suitable location

X					180	
X	Self-Contained	0	Non-Maintained	A	Including test device (Manual Test)	
		1	Maintained	F	Self-test according to IEC 61347-2-7, EL-T marked	
					180	Duration (Minutes)

Identify the installation date on the label

High Temp. LFP Battery
Installation Date:

1	2	3	4	5	6	7	8	9	10	11	12
2024	2025	2026	2027	2028	2029	2030	2031	 LFP			

Notes: If users would like to change the batteries pack, please use the nominated models of Red Arrow, then it will be under warranty.

INS/EMERGENCY_TESTING_SHEET/V4