

# INSTALLATION INSTRUCTIONS

**Sentry Access Control System - Panel with Remote Control**  
 Product Codes: **SENTRY/PANA**

## Safety Warning



- The installation should be carried out by a qualified electrician in compliance with the current edition of the IEE Wiring Regulations.
- Prior to installation, carry out the necessary risk assessment considering the people who could be at risk, the level of risk and the precautions required to control the risk
- Ensure that the circuit supply is isolated either by the circuit supply fuse being removed or the applicable circuit breaker being turned off before installation or any maintenance.
- Check the total load on the circuit ensuring the luminaire does not exceed the rating of the circuit cable, fuse or circuit breaker.
- Long-term use and voltage fluctuations can reduce the life span of the fitting.
- If the fitting incorporates control gear, ensure careful sizing to avoid instances of nuisance tripping of the protective device used in the installation.
- Follow the provided installation instructions, using the fixings supplied or recommended.
- Keep out of reach of children.



## Specification

**Box Contents -**  
 1 x Sentry Panel

<b>Dimensions:</b>	L: 300 x W: 300 x D: 43mm
<b>Material:</b>	Aluminium Body & PS Diffuser
<b>Working Temperature:</b>	Standard: -20°C - 45°C
<b>Included:</b>	IP65 Driver housing with flicker free driver 1 x Hand Held Remote Control 2 x Hanging Loops 4 x Adhesive Fixing Pads 3 x Cable Ties 4 x M4 Screws

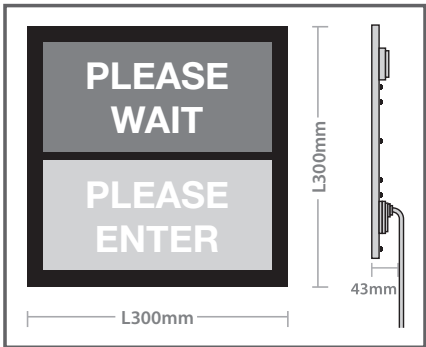

## Installation Instructions

Sentry can be installed using several methods. We recommend option A (suspended) or option B (floor standing). Sentry can also be mounted to the rear of a glass panel using the adhesive fixing pads supplied (option C). This is a temporary mounting solution.

### Option A - Suspended

- Locate the hanging loops on the rear of the panel and measure the distance between the centres.
- Fix suitable hooks (not supplied) to the preferred mounting location. Place the hanging loops over the hooks to support the panel.
- Plug the panel into a mains power socket outlet.

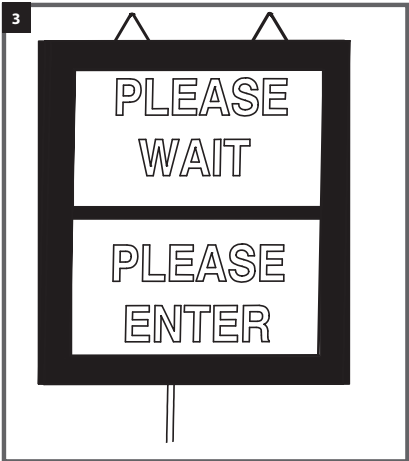
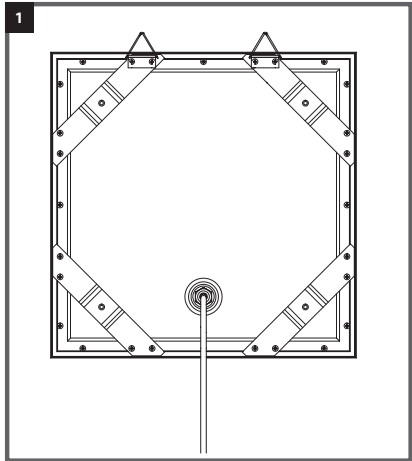

### Option B - Floor Standing (using optional Stand. Order Ref: SENTRY/STD)

---

1. Assemble the stand, following the instructions supplied with the stand.
2. Fix the panel to the stand using the 4 x M4 screws supplied in this pack. Position the panel on the front of the X-Bracket and secure using the M4 screws from the back of the X-Bracket.

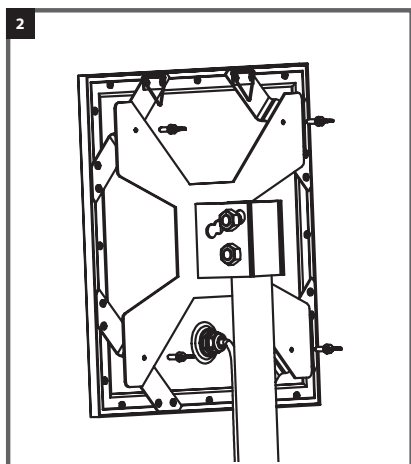

3. Secure cable to upright of stand using cable ties.

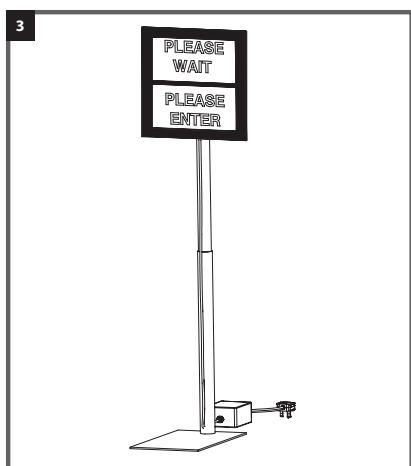

4. Plug the panel into a mains power socket outlet.

### Option C - Glass Mounted (temporary fixing)

---

1. Stick an adhesive fixing pad (supplied) to the front face of the panel frame, one in each corner.

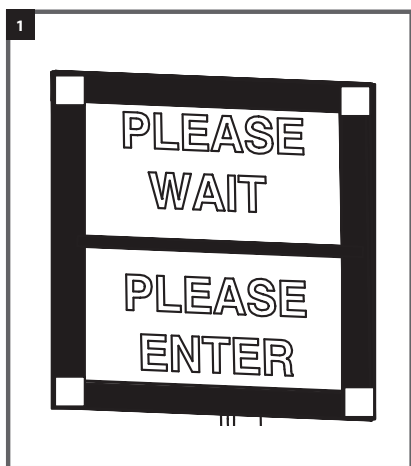

2. Position the panel in the desired location on a glass pane, so that the red / green sign can be seen from the other side of the glass.

3. Remove paper covers and stick pads to the glass.

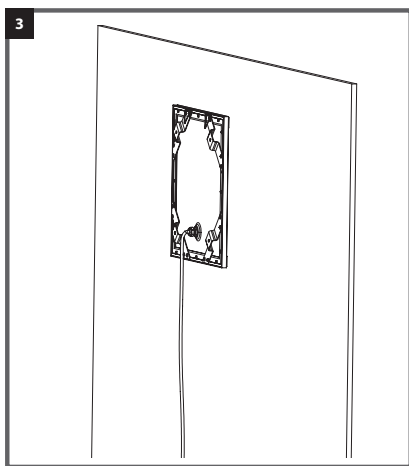

4. Plug the panel into a mains power socket outlet.

## Guarantee

This product is guaranteed for a period of 3 years from the date of purchase. The guarantee is invalid in the case of improper use, tampering, removal of the Q.C. date label, installation in an improper working environment or installation not according to the current edition of the I.E.E. Wiring Regulations (BS7671). The guarantee is also invalidated if the luminaire has been insulation tested. Should this product fail during the guarantee period it will be replaced free of charge, subject to correct installation and return of the faulty unit. We do not accept responsibility for any installation costs associated with the replacement of this product. Your statutory rights are not affected. We reserve the right to alter specifications without prior notice.

## Maintenance

- This fitting will require routine cleaning if used in adverse (dust, paint, welding, oils etc) environments. Do not use solvents, aggressive detergents or abrasives.
- The driver in this luminaire can be quickly and easily replaced at end of life. This should be carried out by a competent person. Contact Red Arrow for details of replacements.
- The light source in this product can not be replaced. When this fitting comes to the end of its life or you choose to replace it, please do not dispose of it with your normal waste. Please recycle where the facilities exist, check with your local authority for suitable options.

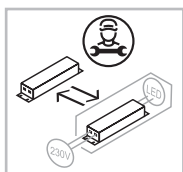

INS/COMMERCIAL/0005/SENTRY\_PANA/V3