

INSTALLATION INSTRUCTIONS

BELLA FIXED 3CCT FIRE RATED DOWNLIGHT

Product Code: **BA/W**

Safety Warning



- The installation should be carried out by a qualified electrician in compliance with the current edition of the IEE Wiring Regulations.
- Prior to installation, carry out the necessary risk assessment considering the people who could be at risk, the level of risk and the precautions required to control the risk.
- Ensure that the circuit supply is isolated either by the circuit supply fuse being removed or the applicable circuit breaker being turned off before installation or any maintenance.
- Check the total load on the circuit ensuring the luminaire does not exceed the rating of the circuit cable, fuse or circuit breaker.
- Long-term use and voltage fluctuations can reduce the life span of the fitting.
- If the fitting incorporates control gear, ensure careful sizing to avoid instances of nuisance tripping of the protective device used in the installation.
- Follow the provided installation instructions, using the fixings supplied or recommended.
- Keep out of reach of children.



Specification

Box Contents -

BELLA 3CCT FIRE RATED DOWNLIGHT

Dimensions:	Fixed: Ø:86 x H:46mm. Cut Out Ø:55-70mm
Material:	Housing: Steel Lens: Polycarbonate
Working Temperature:	-20°C - 25°C
Included:	Tool-free connector

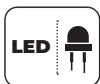
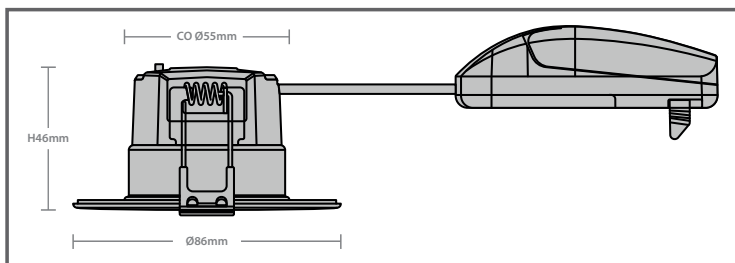

*From Below Ceiling

MAXIMUM FITTINGS PER CIRCUIT

Automatic Circuit Breaker Type:	B6	B10	B13	B16	B20	C10	C13	C16	C20
Rated Current:	6A	10A	13A	16A	20A	10A	13A	16A	20A
Cable (mm):	1.5	1.5	2.5	2.5	4	1.5	2.5	2.5	4
BA/W	45	85	110	135	170	175	225	280	250

Installation Instructions

- Ensure the downlight will fit into the ceiling void, avoiding obstructions such as joists or services.
- Cut out the correct diameter hole in the required location: Fixed = 55-70mm diameter.
Note: The fitting is suitable to be covered with insulating material.
- Feed the power supply cable through the hole.

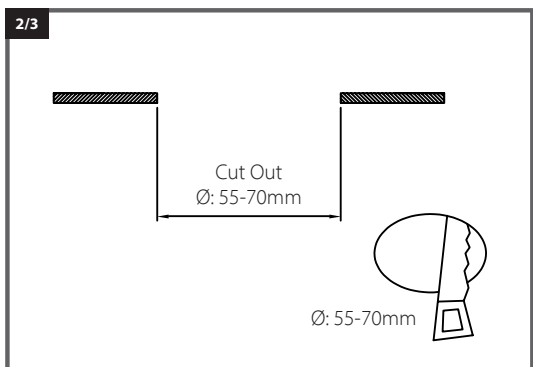

4. Lift the hinged cover/strain relief on the terminal block and connect the supply cable(s) to the push-fit terminals, ensuring correct polarity.
5. To change the colour appearance (CCT) of the LEDs, locate the three-position dip switch on the back of the product. Select the desired CCT by sliding the switch: left = WW-3000K, centre = CW-4000K, right = DL-6500K.
6. Pass the supply cable and driver through the ceiling aperture. Push up the spring clips and offer the downlight into the ceiling until it sits flush and secure.
7. The white bezel is fixed as standard. To change the bezel trim colour, align the new bezel with the standard bezel and push it upwards until it clicks into place.
8. Restore the power supply and check for correct operation.

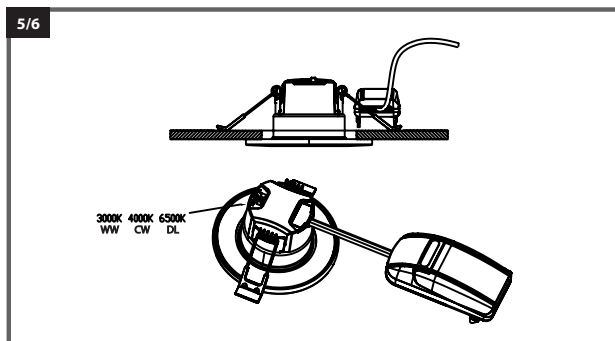
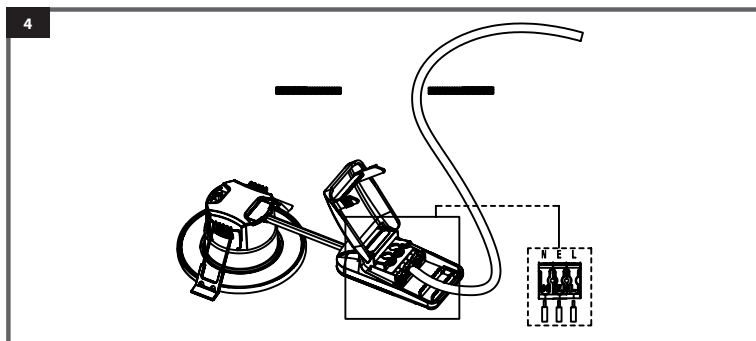

Replacement Bezels

- The downlight is supplied with a matt white bezel as standard fixed. This can be changed to other colour finish bezels, ordered separately.
- A wide range of bezel colour finishes are available to fit this downlight.
- For full details and up to date list visit redarrowelectrical.co.uk or contact Red Arrow Sales

Warranty

This product is covered by a 3 year warranty from the date of purchase. The warranty is invalid in the case of improper use, tampering, removal of the Q.C. date label, installation in an improper working environment or installation not according to the current edition of the I.E.E. Wiring Regulations (BS7671). The warranty is also invalidated if the luminaire has been insulation tested. Should this product fail during the warranty period it will be replaced free of charge, subject to correct installation and return of the faulty unit. We do not accept responsibility for any installation costs associated with the replacement of this product. Your statutory rights are not affected. We reserve the right to alter specifications without prior notice.

Maintenance

- This fitting will require routine cleaning if used in adverse (dust, paint, welding, oils etc) environments. Do not use solvents, aggressive detergents or abrasives.
- The LEDs and Driver in this product are non-replaceable at the end of life. When either the driver or LEDs reaches end of life, the whole luminaire should be replaced.

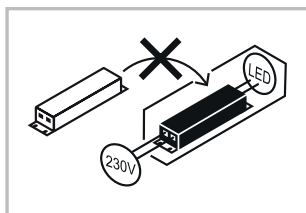
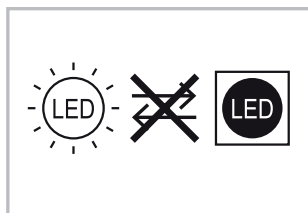

- When this fitting comes to the end of its life or you choose to replace it, please do not dispose of it with your normal waste. Please recycle where the facilities exist, check with your local authority for suitable options.

INS/DOWNLIGHTS/0012/BA/V1