

Circular Gear Trays

Product Codes: **GTC15EVO-CCT-V2, GTC18EVO-CCT-V2**

Safety Warning



- The installation should be carried out by a qualified electrician in compliance with the current edition of the IEE Wiring Regulations.
- Prior to installation, carry out the necessary risk assessment considering the people who could be at risk, the level of risk and the precautions required to control the risk
- Ensure that the circuit supply is isolated either by the circuit supply fuse being removed or the applicable circuit breaker being turned off before installation or any maintenance.
- Check the total load on the circuit ensuring the luminaire does not exceed the rating of the circuit cable, fuse or circuit breaker.
- Long-term use and voltage fluctuations can reduce the life span of the fitting.
- If the fitting incorporates control gear, ensure careful sizing to avoid instances of nuisance tripping of the protective device used in the installation.
- Follow the provided installation instructions, using the fixings supplied or recommended.
- Keep out of reach of children.



Specification

Box Contents -
1 x Circular Gear Tray

Dimensions:	Standard: Ø: 244 x D: 29mm
Material:	Phenolic Resin
Working Temperature:	Standard: -20°C - 40°C
Included:	Fast Fit Terminal Block

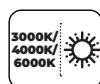
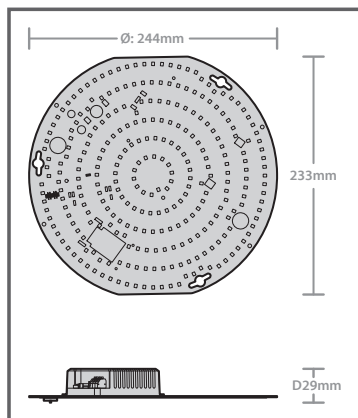

MAXIMUM FITTINGS PER CIRCUIT

Automatic Circuit Breaker Type:	B6	B10	B13	B16	B20	C10	C13	C16	C20
Rated Current:	6A	10A	13A	16A	20A	10A	13A	16A	20A
Cable (mm):	1.5	1.5	1.5	2.5	2.5	1.5	1.5	2.5	2.5
GTC15EVO-CCT-V2	30	51	66	81	102	70	90	120	150
GTC18EVO-CCT-V2									

Installation Instructions

Note: This is a class II electrical product - no earth required

1. Isolate the mains supply before commencing with the installation.
2. A. Install the Red Arrow POLO X or Robust Round Body only.
Or
B. Prepare existing housing ready to install the gear tray - checking that the retaining screw positions are compatible with those of the gear tray.
3. A. Feed the mains cable into the housing.
B. If the housing is not already installed, hold the fitting up to the ceiling / wall in the desired position and mark hole fixing centres.
C. Drill fixing holes.
D. Insert Rawl Plugs.
E. Fix in position.

- Ensure the luminaire has a switched live supply to "Ls" (switched live). Route the mains supply cable to the terminal block on the gear tray and terminate, ensuring correct polarity is observed. Ensure all conductors are fully sleeved and insulated.

Note: If converting to Emergency with the EM Kit (Supplied separate) the luminaire will require a secondary unswitched live supply "L" as well as a switched supply. The unswitched supply "L" must be taken from the same phase as the "switched" supply and must be wired to the same MCB so that upon test, it is isolated at the same time as the switched supply.

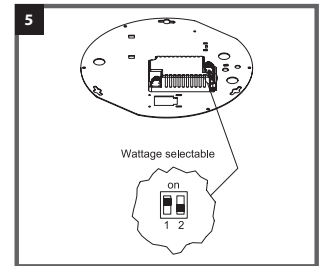
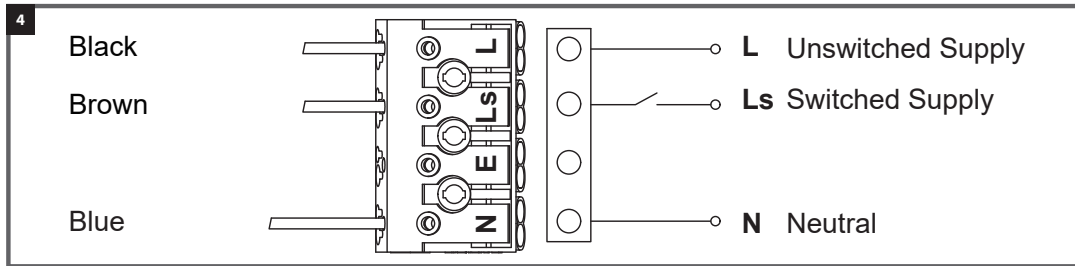

- Select the desired wattage using the dip switches on the driver.
- If using the emergency or microwave sensor plug and play kits (supplied separate) it is suggest to install these onto the geartray at this point. (Instructions are provided with the kits)
- Refit the geartray and secure into position, ensuring no cables are trapped before tightening the screws.
- Set the specified colour temperature using the switch located on the front of the LED Board.

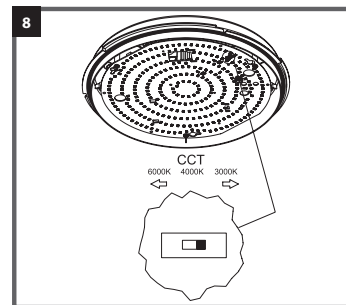
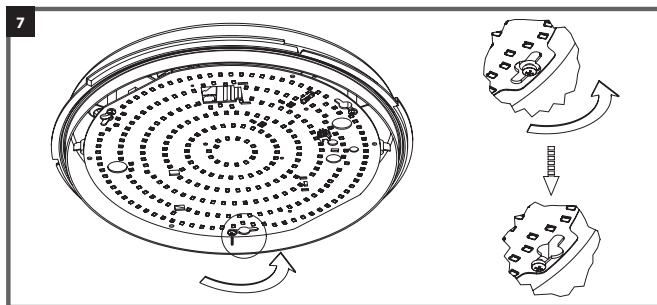

- Refit the diffuser and any trims. Restore the mains power supply, switch on and test for satisfactory operation.

Important: This gear tray is designed for use with Red Arrow POLO / POLO X / Robust Round Empty Bodies. When installing this gear tray into an existing housing not supplied by Red Arrow, we strongly recommend that the internal volume of the housing is no less than 3500cm³ (3.5 litres), for thermal considerations.

Warranty

This product is guaranteed for a period of 5 years from the date of purchase. The warranty is invalid in the case of improper use, tampering, removal of the Q.C. date label, installation in an improper working environment or installation not according to the current edition of the I.E.E. Wiring Regulations (BS7671). The warranty is also invalidated if the luminaire has been insulation tested. Should this product fail during the warranty period it will be replaced free of charge, subject to correct installation and return of the faulty unit. We do not accept responsibility for any installation costs associated with the replacement of this product. Your statutory rights are not affected. We reserve the right to alter specifications without prior notice.

Maintenance

- This fitting will require routine cleaning if used in adverse (dust, paint, welding, oils etc) environments. Do not use solvents, aggressive detergents or abrasives.
- The light source & driver in this luminaire can be quickly and easily replaced at end of life. This should be carried out by a competent person. Contact Red Arrow for details of replacements.

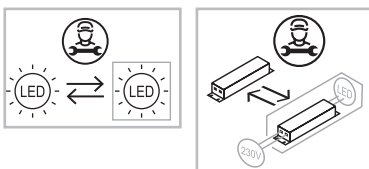

- When this fitting comes to the end of its life or you choose to replace it, please do not dispose of it with your normal waste. Please recycle where the facilities exist, check with your local authority for suitable options.

INS/BLK/0005/GTCEVO_CCT_V2