

## PIR Sensors

Product Codes: **PIR-B180/360**

### Safety Warning



- The installation should be carried out by a qualified electrician in compliance with the current edition of the IEE Wiring Regulations.
- Prior to installation, carry out the necessary risk assessment considering the people who could be at risk, the level of risk and the precautions required to control the risk
- Ensure that the circuit supply is isolated either by the circuit supply fuse being removed or the applicable circuit breaker being turned off before installation or any maintenance.
- Check the total load on the circuit ensuring the luminaire does not exceed the rating of the circuit cable, fuse or circuit breaker.
- Long-term use and voltage fluctuations can reduce the life span of the fitting.
- If the fitting incorporates control gear, ensure careful sizing to avoid instances of nuisance tripping of the protective device used in the installation.
- Follow the provided installation instructions, using the fixings supplied or recommended.
- Keep out of reach of children.



### Specification

**Box Contents -**  
1 x PIR Sensor

<b>Dimensions:</b>	L: $\Phi 78$ x W: 76 x D: 91.5 mm
<b>Material:</b>	Flame Retardant ABS
<b>IP Rating:</b>	IP65
<b>Working Temperature:</b>	-20°C to 40°C
<b>Warranty</b>	1 Year

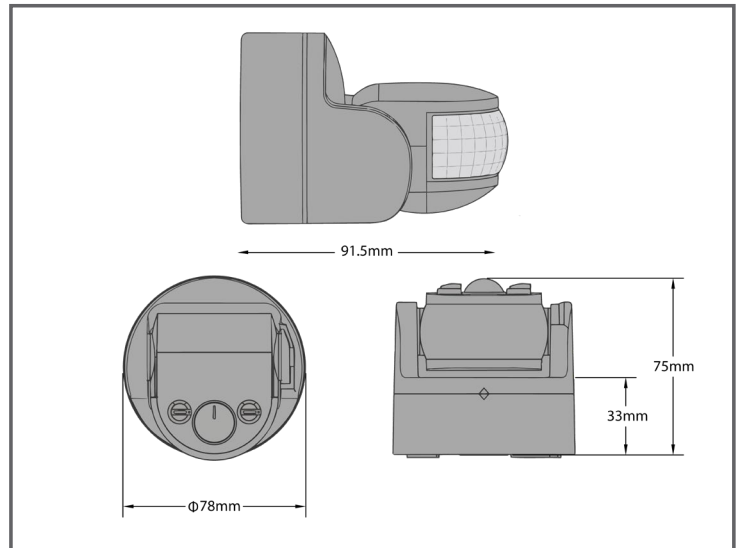

### Installation Instructions

- Find suitable mounting location for optimum detection
- Remove sensor from base by loosening grub screws at either side (Fig 1.)
- Mount base at a height between 1.8-2.5m
- Wire as per (Fig 3)
- Reassemble the sensor

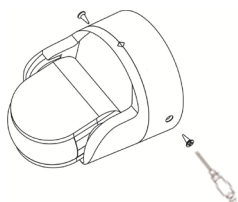

Figure 1

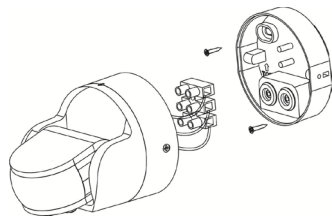

Figure 2

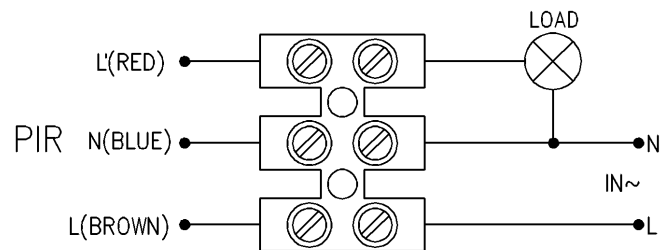
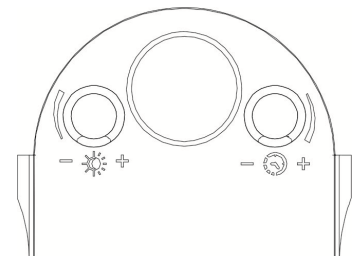

Figure 3

### 5. Test:

- Turn the LUX knob clockwise on the maximum (sun). Turn the TIME knob anti-clockwise on the minimum (10s).
- Switch on the power; the sensor and its connected lamp will have no signal at the beginning. After Warm-up 30sec, the sensor can start work. If the sensor receives the signal, the lamp will turn on. While there is no another signal any more, the load should stop working within 10sec $\pm$ 3sec and the lamp would turn off.
- Turn LUX knob anti-clockwise on the minimum (-). If the ambient light is more than 10LUX, the sensor would not work and the lamp stop working too. If the ambient light is less than 10LUX (darkness), the sensor would work. Under no signal condition, the sensor should stop working within 10sec $\pm$ 3sec.
- Note: when testing in daylight, please turn LUX knob to ☀ (SUN) position, otherwise the sensor lamp could not work! If the lamp is more than 60W, the distance between lamp and sensor should be 60cm at least.



## Problems & Solutions

### The load does not work:

- Please check if the connection of power source and load is correct.
- Please check if the load is good.
- Please check if the settings of working light correspond to ambient light.

### The sensitivity is poor:

- Please check if there are any objects in front of the detector to affect it to receive the signals.
- Please check if the ambient temperature is too high.
- Please check if the induction signal source is in the detection field.
- Please check if the installation height corresponds to the height specified in the instruction.
- Please check if the moving orientation is correct.

### The sensor cannot shut off the load automatically:

- Please check if there is continuous motion in the detection field.
- Please check if the time delay is set to the maximum position.
- Please check if the power corresponds to the instruction.
- Please check if the temperature near the sensor changes obviously, such as air condition or central heating etc.

## Sensor Information

### Technical Parameters:

Detection Range: 180°+360°

Detection Distance: 12m max(<24°C)

Time Delay: Min.10sec±3sec, Max.15min±2min

Rated Load: 300W (LED)

Ambient Light: <10-2000 LUX (adjustable)

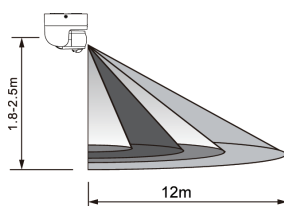

Height of installation: 1.8-2.5m

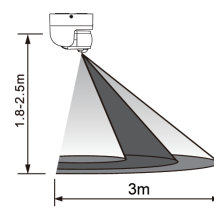

Height of installation: 1.8-2.5m

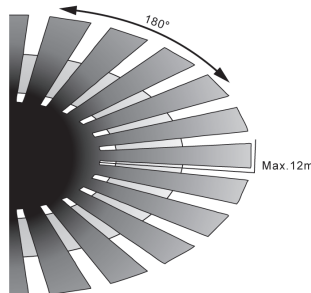

Detection Distance: 12m

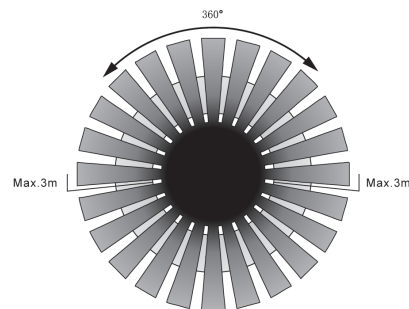

Detection Distance: 3m

## Warranty

This product warranty is for a period of 1 year from the date of purchase. The warranty is invalid in the case of improper use, tampering, removal of the Q.C. date label, installation in an improper working environment or installation not according to the current edition of the I.E.E. Wiring Regulations (BS7671). The warranty is also invalidated if the luminaire has been insulation tested. Should this product fail during the warranty period it will be replaced free of charge, subject to correct installation and return of the faulty unit. We do not accept responsibility for any installation costs associated with the replacement of this product. Your statutory rights are not affected. We reserve the right to alter specifications without prior notice.

## Maintenance

- This sensor will require routine cleaning if used in adverse (dust, paint, welding, oils etc) environments. Do not use solvents, aggressive detergents or abrasives.
- When this sensor comes to the end of its life or you choose to replace it, please do not dispose of it with your normal waste. Please recycle where the facilities exist, check with your local authority for suitable options.

INS/ACCESSORIES/0007/PIR/PIR-B180/360